



MARCEGAGLIA

steel building home products engineering energy tourism services

ARENDI S.p.A.

START-UP OF A INDUSTRIAL LINE FOR THE PRODUCTION OF THIN FILM PHOTOVOLTAIC MODULES

Roberto Garavaglia
CEO

**“Leading Low-Carbon Technology in Italy and the U.S. :
Moving Research from the Laboratory to the Market”**

Rome May 26, 2009

ICE – Istituto Nazionale per il Commercio Estero

Moving Research From Lab to Industry

- CdTe-CdS PV modules are very stable and made with easily scalable techniques
- University of Parma began lab tests several years ago
- An Italian Newco (Arendi) has been established in 2006 to invest in the industrial project
- An industrial line based on well known technology (sputtering) and some patented innovative solutions (Closed Space Sublimation) is under start-up in Northern Italy

Moving Research From Lab to Industry

- The project has been fostered by the Italian Ministry of Environmental and the Region Lombardia
- Target Annual Production is 15 MWp equivalent to 200.000 PV modules with size 0.6 m by 1.2 m
- Site and facilities already designed for a 30 MW production
- Highly automated industrial line

Arendi partners:

- Euroenergy Srl - Marcegaglia Group (engineering and contracting in renewable energy field)
- Solar Systems & Equipments Srl (research in PV field, in cooperation with University of Parma)
- Alchimia Spa (financial partner)
- Banca Ifis SpA (financial partner)
- Studio Galli Ingegneria Spa (engineering)

Partners for Industrial Phase:

- Basic Design - Italy
- Equipment Supply- Italy
- Human Resources - Italy
- Raw materials EU – USA – Far East
- Sales Market - Italy and Southern Europe

Short Description of the Technology:

- Arendi has developed a new simplified process
- The innovative solutions are protected with five patents
- Lab efficiency close to 16%



Structure of CdS / CdTe Cell :

The CdTe/CdS thin film cell is composed of four layers:

- The Transparent Coating Oxide (TCO) layer, acting as front contact
- The CdS layer, acting as n-type partner
- The CdTe layer, acting as p-type absorber
- The back contact

Structure of CdTe / CdS cell

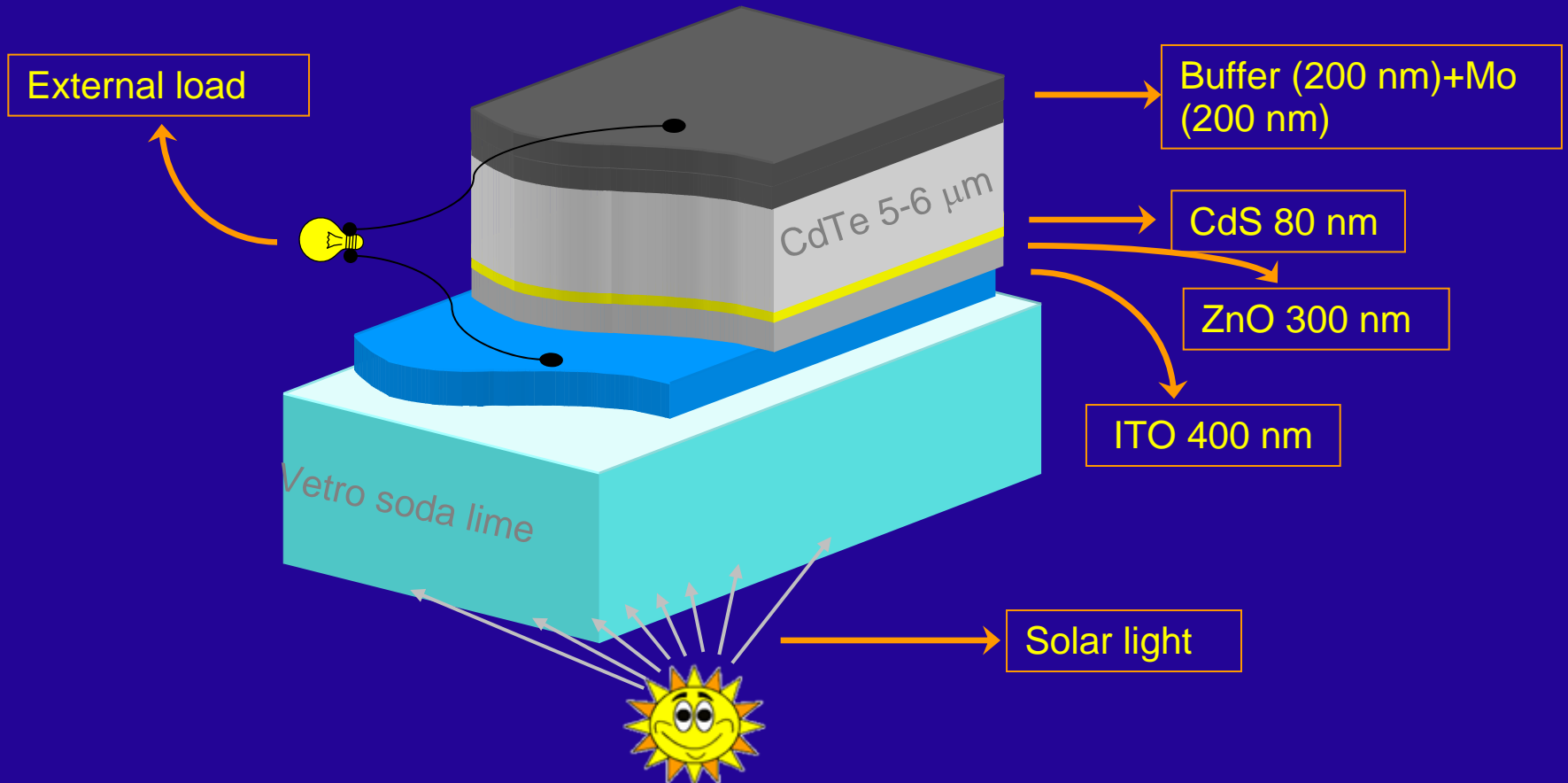

Short Description of the In-line Process:

Divided in three sections :

- Section 1 : TCO
- Section 2 : CdS and CdTe deposition with CdTe treatment in Cl atmosphere
- Section 3 : Back Contact

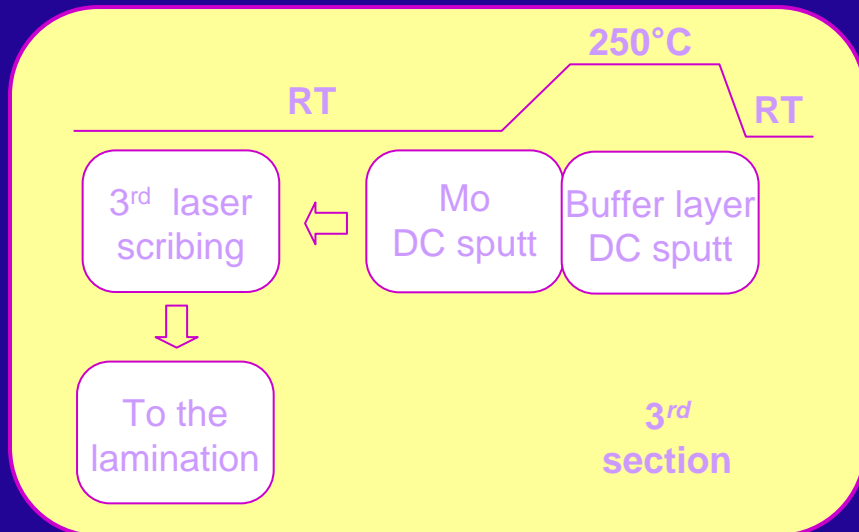
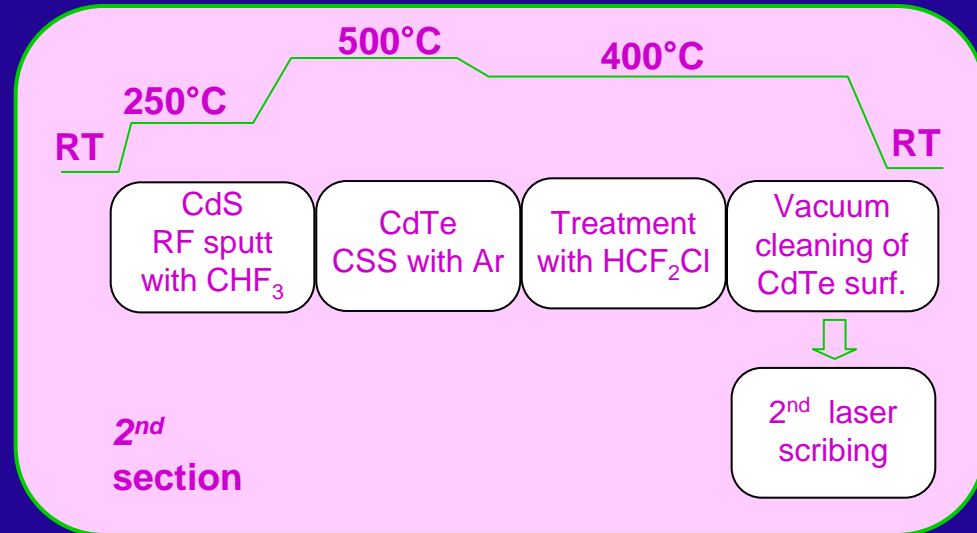
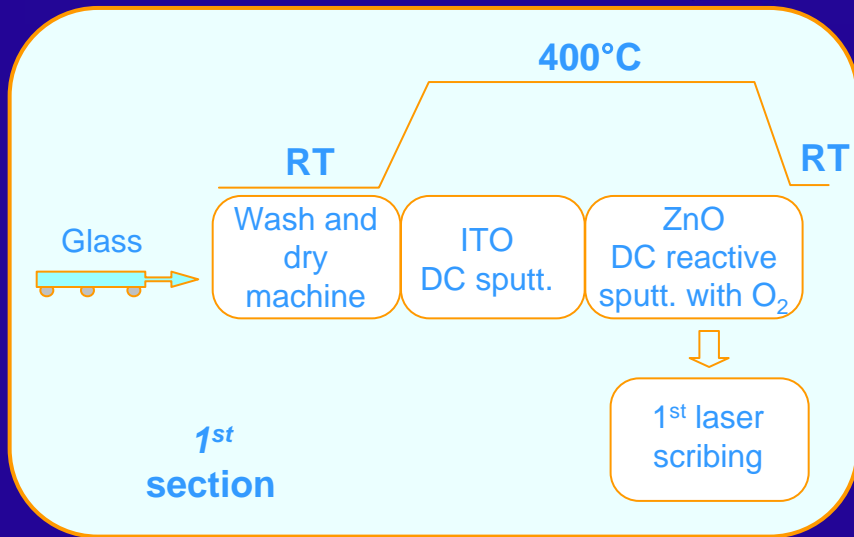

Technology topics

- **Innovative technologies**
 - Full dry process
 - CdS deposition obtained with RF Sputtering
 - Innovative back contact
- **Adopted standards**
 - Continuous production cycle with very limited emissions

Strengths

- Robust production process
- Industrial scalability
- Thin Film technology minimizing utilization of raw materials
- High efficiency modules
- Stability over time

Enviromental aspects

Arendi is part of the PV Cycle organization founded in July 2007 to implement the photovoltaic industry's commitment to set up a voluntary take back and recycling programme for end-of-life-modules and to take responsibility for PV modules throughout their entire value chain.

Our Company is therefore strongly committed to offer a truly sustainable energy solution today to help prevent climate change tomorrow

Cooperation with U.S. organization

- A fruitful cooperation has been established with First Solar on Environmental Safety and Health (EHS) in order to avoid any misunderstanding with our local institution on this important topic.
- Contacts with Universities through our technology partners

State of the project

- June '07
Start of the executive planning
- September '09
Delivery of first equipment and start set-up
- December '09
Delivery of the complete industrial line
- January '10 – March '10
Start of modules production

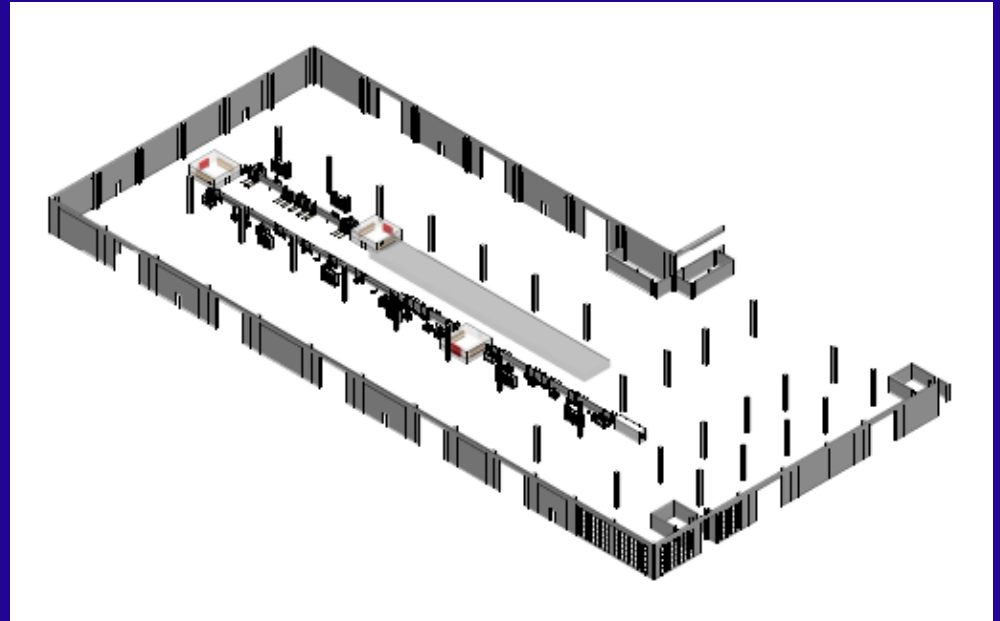

The Italian response to the demands of the international photovoltaic industry:

- Arendi investment is the sole project developed at the date in Italy on an Italian proprietary know how
- The project is well positioned to effectively compete in the global photovoltaic market
- The competitive industrial cost will allow a more widespread diffusion of the photovoltaic applications
- Solutions are already available for total building integration



MARCEGAGLIA

steel building home products engineering energy tourism services

ARENDI S.p.A.

Contact

Production Site

Via Ceresio 14

Arendi S.p.A

Lonate Pozzolo (VA)

Ph. +39 0331 660912

arendi@marcegaglia.com

THANK YOU FOR THE ATTENTION